

30" PRO-STYLE® RANGETOP

JGCP430WP – 29³/₄" x 14⁵/₈" x 28³/₈"

PRODUCT DIMENSIONS

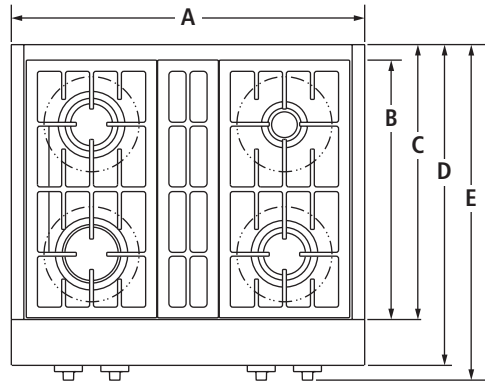

TOP VIEW

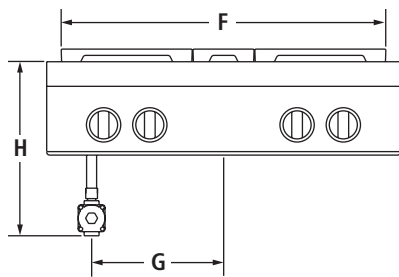

FRONT VIEW

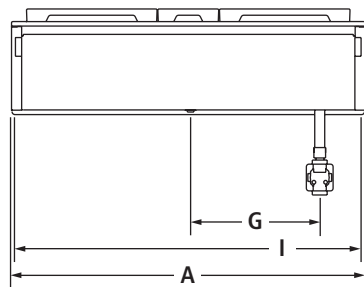

BACK VIEW

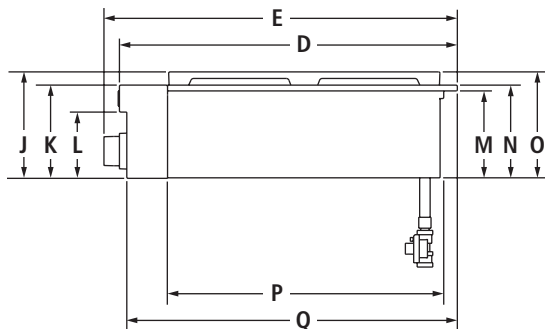

SIDE VIEW

MODEL #		JGCP430WP	
		in	cm
A	Overall width	29 ³ / ₄	75.6
B	Depth of grates	21 ³ / ₄	55.2
C	Depth without control panel	23 ¹ / ₄	59.0
D	Depth with control panel overhang	27 ¹ / ₈	68.9
E	Depth with knobs	28 ³ / ₈	72.0
F	Width of grates	27	68.6
G	Center of rangetop to center of gas inlet	11	28.1
H	Height from gas inlet to cooking surface	14 ⁵ / ₈	37.1
I	Width of recessed rangetop	29 ¹ / ₈	73.9
J	Height including grates	8 ¹ / ₂	21.7
K	Height of control panel	7 ¹ / ₂	19.0
L	Height to bullnose	5 ³ / ₈	13.5
M	Height of recessed rangetop	7	17.7
N	Height to cooking surface	7 ³ / ₈	18.8
O	Height of recessed rangetop with grates	8 ¹ / ₂	21.6
P	Depth of recessed rangetop	22 ¹ / ₈	56.3
Q	Depth with control panel	26 ¹ / ₂	67.3

IMPORTANT: Dimensional specifications are provided for planning purposes only.Do not make any cutouts based on this information. Refer to the Installation Guide *before* selecting cabinetry, verifying electrical/gas connections, making cutouts or beginning installation.

All Jenn-Air® appliances are appropriately UL, CUL or CSA approved.

30" PRO-STYLE® RANGETOP

JGCP430WP – 29³/₄" x 14⁵/₈" x 28³/₈"

OPENING/CLEARANCE DIMENSIONS

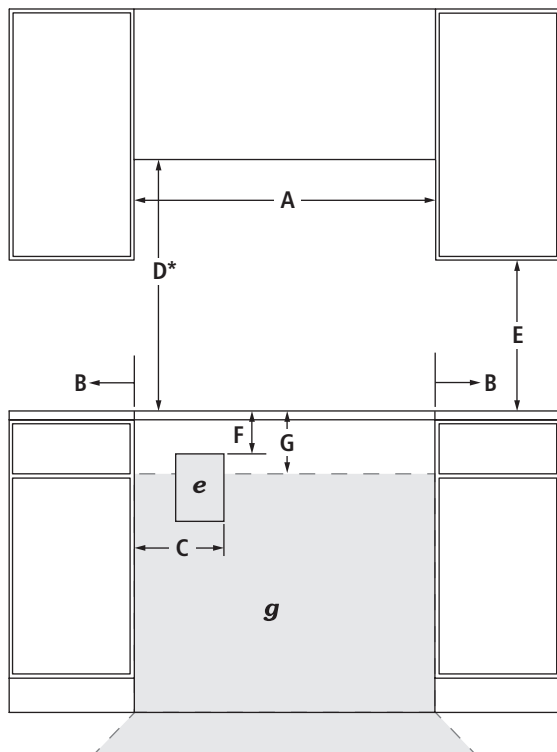

FRONT VIEW

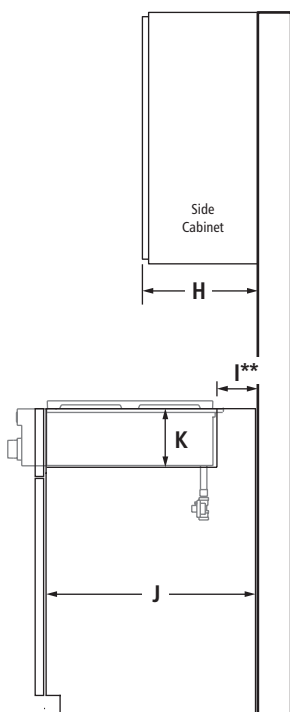

SIDE VIEW

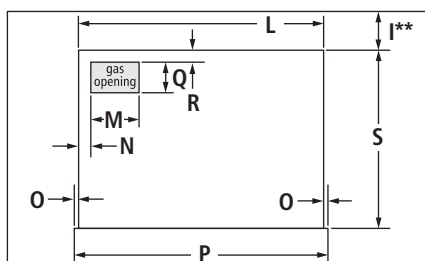
TOP VIEW – CUTOUT
(solid platform not shown)

MODEL #		JGCP430WP	
		in	cm
A	Width of combustable area above cooking surface (min.)	30	76.2
B	Width from rangetop to fixed wall or other combustable material (min.)	6	15.2
C	Width to inner edge of outlet (max.)	16	40.6
D*	Height to bottom of uncovered wood or metal cabinet above cooking surface (min.)	30	76.2
E	Height to bottom of uncovered wood or metal cabinet (min.)	18	45.7
F	Height to top edge of outlet (min.)	10	25.4
G	Height to gas supply line area	14	35.6
H	Depth of upper cabinet (recommended)	13	33.0
I**	Depth from cutout to wall	1 ³ / ₄	4.4
J	Depth of cabinet	24	61.0
K	Height from cabinet to countertop	7 ¹ / ₄	18.4
L	Width of cutout (countertop and cabinet)	29 ¹ / ₄	74.3
M	Width of gas opening	12 ¹ / ₂	31.7
N	Width from cutout to gas opening	2	5.1
O	Width of notch	3 ³ / ₈	1.0
	Zero clearance	5 ¹ / ₁₆	0.8
P	Width of cutout (countertop only)	30	76.2
	Zero clearance	29 ⁷ / ₈	75.9
Q	Depth of gas opening	6 ⁷ / ₈	17.5
R	Depth from cutout to gas opening	3 ³ / ₄	1.9
S	Depth of cutout (countertop and cabinet)	22 ¹ / ₄	56.5
e	Recommended electrical outlet location		
g	Recommended gas supply line location		

*Dimension can be reduced by 6" (15.2 cm) when bottom of wood or metal cabinet is covered by not less than 1/4" (0.6 cm) flame retardant millboard covered with not less than No. 28 MSG sheet metal, 0.015" (0.4 mm) stainless steel, 0.024" (0.6 mm) aluminum or 0.020" (0.5 mm) copper.

If installing a hood above the rangetop, follow the hood instructions for dimensional clearances above the cooking surface.

**If back wall is constructed of a combustable material and a backsplash is not installed, a 1 3/4" (4.4 cm) minimum clearance is required.

GAS REQUIREMENTS

Natural Gas

This rangetop is factory-set for use with natural gas.

LP Gas Conversion

Conversion must be done by a qualified service technician. To convert to LP gas, use the LP gas conversion kit provided with the rangetop.

ELECTRICAL REQUIREMENTS

120 volt, 60 Hz, AC only, 15-amp fused, electrical circuit is required.

A time-delay fuse or dedicated circuit is recommended.

IMPORTANT: Dimensional specifications are provided for planning purposes only.

Do not make any cutouts based on this information. Refer to the Installation Guide *before* selecting cabinetry, verifying electrical/gas connections, making cutouts or beginning installation.

All Jenn-Air® appliances are appropriately UL, CUL or CSA approved.