

800 Series, Compact Washer, max. 1600 rpm, Pearl Steel WGB246AXUC



- **i-DOS:** automatically measures the precise amount of detergent and water needed.
- **4D Wash System:** highly efficient water and detergent penetration for spotless results.
- **10kg capacity gives you the opportunity to fit more in one wash, saving time and energy while providing perfect washing results.**
- **SuperQuick 15/30™:** features a 30 minute quick wash cycle or 15 minutes with the SpeedPerfect® option
- **ActiveWater™ Plus:** adjusts water consumption according to the load size using automatic load detection technology

Leak protection system: AquaStop Plus
 Maximum spin speed: 1600 rpm
 Spin speed options: Variable
 Display: Yes
 Status Indicator: LED-Display



4 242005 415823

WMZ2200	Floor securing component
WMZ2381	Extension for cold water inlet /AquaStop
WMZPW2XW	Platform with pull-out, washer, cubic
WTZPA20UC	RNA Power Adapter, Dryer
WTZPA30US	RNA Power Adapter, Dryer (3-Prong)

**800 Series, Compact Washer, max.
1600 rpm, Pearl Steel
WGB246AXUC**

measurements in inches

Guidance for location of Dryer receptacle and Water taps to minimize depth allowance (Not to Scale)

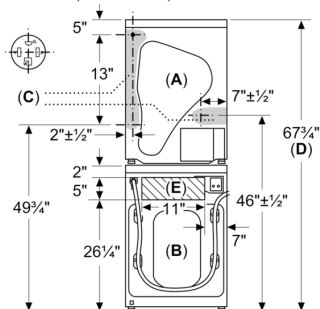

- A: Dryer
- B: Washer
- C: Axis lines, in shaded areas, indicate Center Line of home's Dryer receptacle for minimal depth allowance if located entirely behind appliances.
- D: Minimum Stack Height (with Stacking Kit)
- E: Hatched area - indicates location for home's Hot and Cold water taps/outlets for minimal depth if located entirely behind appliances.

Installer / Customer is responsible for fit, function, maintenance and safety of utility installation.

measurements in inches

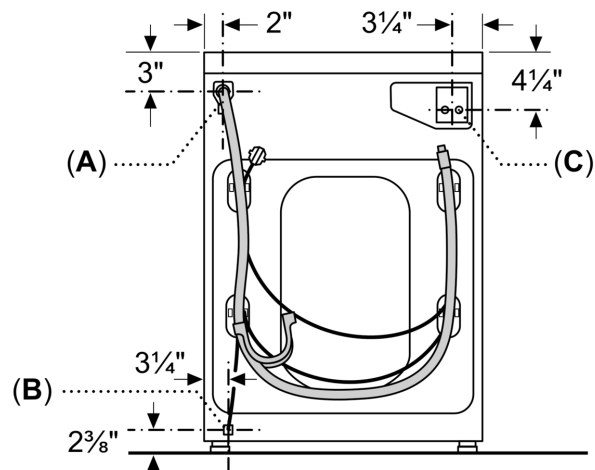

- A: Drain exit
- B: Power cord exit
- C: Supply hoses (Hot and Cold)

Measurements in mm

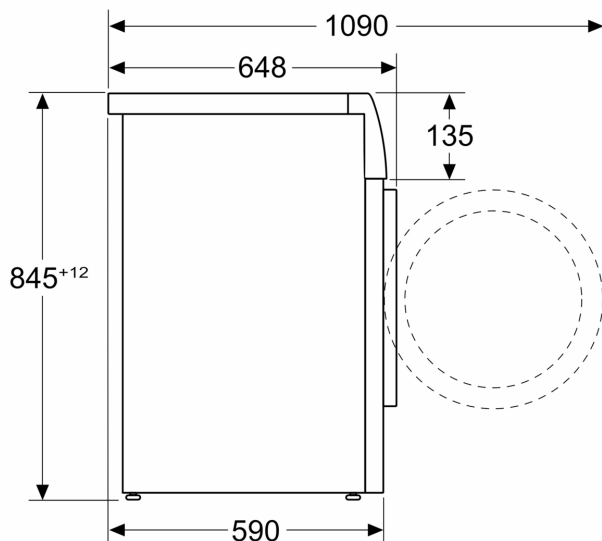

Measurements in inches

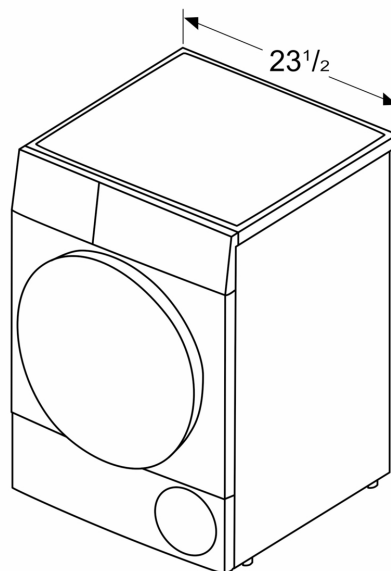

Measurements in inches (mm)

