

# Installation Instructions

## Grind and Brew Coffee Maker

### Water Filter

#### IMPORTANT SAFETY INFORMATION

READ ALL INSTRUCTIONS BEFORE USING THE APPLIANCE

#### ⚠ WARNING

To reduce the risk associated with ingestion of contaminants, do not use with water that is micro-biologically unsafe or of unknown quality. This indicates a hazardous situation which if not avoided could result in death or serious injury.

For proper performance, this filter **MUST** be installed in accordance with these instructions. Manufacturer assumes no responsibility or liability for damages arising out of misuse of this product.

**NOTE:** When performing a descale cycle, please remove filter first.

**Replacement:** Replace filter every 2 months or 25 gallons of water when the "Water Filter" alert appears on UI.

1. Carefully remove the charcoal water filter from the packaging and rinse with cold water.

**NOTE:** Rinsing the charcoal water filter with cold water before the first use helps remove loose charcoal particles.

2. Remove the water reservoir from the base. See Figure: 1.
3. Unscrew the charcoal water filter Cartridge, located on the bottom of the water reservoir, by rotating the winged cap counter-clockwise 90° with your hand. See Figure: 2
4. Place the charcoal water filter with the rounded bottom facing down into the charcoal water filter cartridge. See Figure: 3.
5. Once the filter is in place, return the charcoal water filter cartridge to the bottom of the water reservoir. Secure the cartridge using the winged cap by rotating the cap clockwise 90°. **DO NOT** over tighten the cartridge. See Figure: 4
6. Place the water reservoir back into the base.

**NOTE:** It is recommended to change the charcoal water filter every two months or when **Water Filter** appears on the display screen. This appears every 25 gallons brewed.

Reorder charcoal water filters from

[geappliances.com/ge/parts/](http://geappliances.com/ge/parts/).

Have your model number ready.

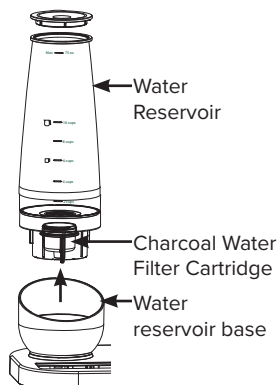

Figure: 1

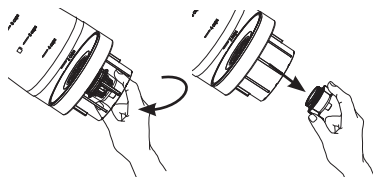

Figure: 2

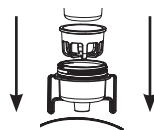

Figure: 3

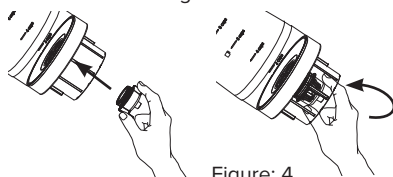

Figure: 4

## Installation Instructions Grind and Brew Coffee Maker Water Filter

### Inserting the Charcoal Water Filter

It is recommended to use a charcoal filter with the Profile Grind and Brew Coffee maker to remove impurities and odors from your water. This helps your coffee maker perform at its best.

1. Carefully remove the charcoal water filter from the packaging and rinse with cold water.

**NOTE:** Rinsing the charcoal water filter with cold water before the first use helps remove loose charcoal particles.

2. Remove the water reservoir from the base. See Figure: 1.
3. Unscrew the charcoal water filter Cartridge, located on the bottom of the water reservoir, by rotating the winged cap counter-clockwise 90° with your hand. See Figure: 2
4. Place the charcoal water filter with the rounded bottom facing down into the charcoal water filter cartridge. See Figure: 3.
5. Once the filter is in place, return the charcoal water filter cartridge to the bottom of the water reservoir. Secure the cartridge using the winged cap by rotating the cap clockwise 90°.  
**DO NOT** over tighten the cartridge. See Figure: 4
6. Place the water reservoir back into the base.

**NOTE:** It is recommended to change the charcoal water filter every two months or when **Water Filter** appears on the display screen. This appears every 25 gallons brewed.

Reorder charcoal water filters from [GEAppliances.com/ge/parts/](http://GEAppliances.com/ge/parts/). Have your model number ready.

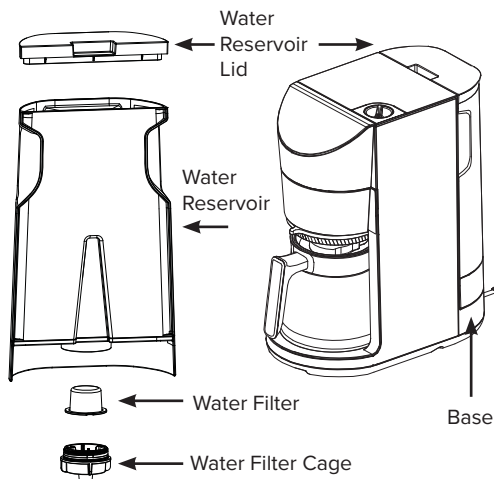

Figure 1

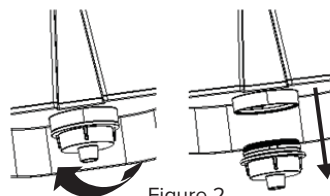

Figure 2

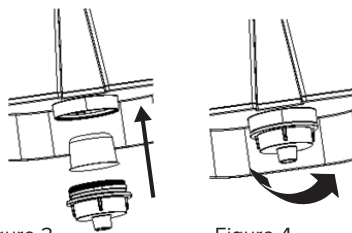

Figure 3

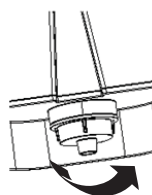

Figure 4