

# FLEXSTEEL®

## W1013-860

### Dresser

#### IMPORTANT NOTES

Carefully remove all the parts from the carton and put them individually on a soft cloth to prevent damage to the parts.

We have taken great care in the design of this product and request that you carefully and accurately follow our assembly instructions to ensure proper set-up. We recommend at least two adults assemble this product.

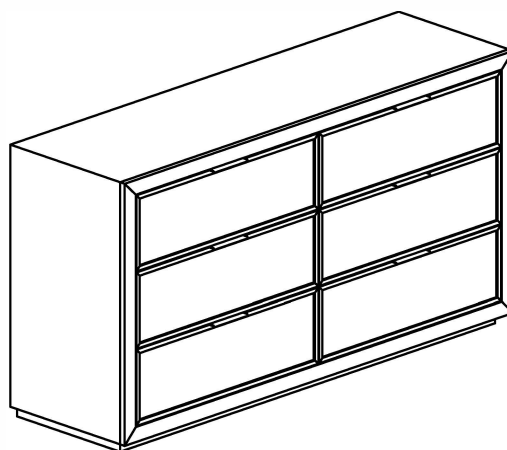

#### Hardware List

#### Assembly Instruction 1/2

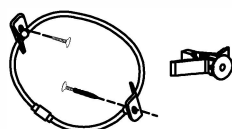

Tip Restraint  
1 set



Not included  
Phillips Screwdriver  
PH2 x 100mm

#### IMPORTANT NOTES

- Use a soft cloth between these parts and the floor.
- We recommend this product be assembled by at least two adults.

#### STEP 1

Adjust the levelers under the base until the furniture is leveled. (See Figure 1).

Figure 1

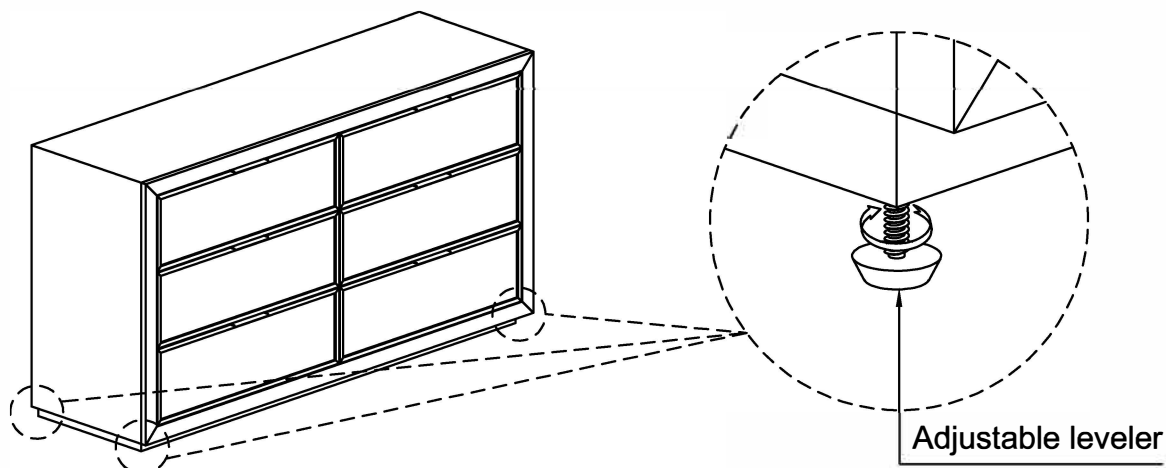

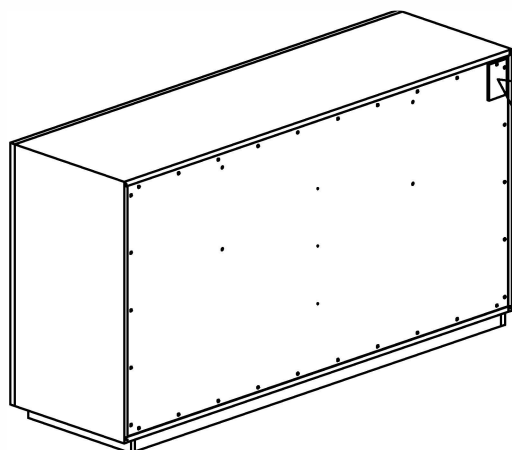

**NOTE:** There is a tip restraint kit provided on the back of this product. Take care to read the instructions thoroughly and install it immediately when placed in the home

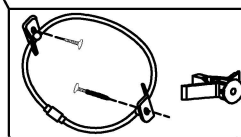

## Drawer Adjustment and Removal

1. If you need to adjust a drawer upward, turn the adjustment knob on the drawer glide counter-clockwise. (See Figure 2).
2. If you need to adjust a drawer downward, turn the adjustment knob on the drawer glide clockwise. (See Figure 3).
3. To remove the drawers, pull the safety pin outward on each drawer glide, then lift the drawer out. (See Figures 4 and 5).

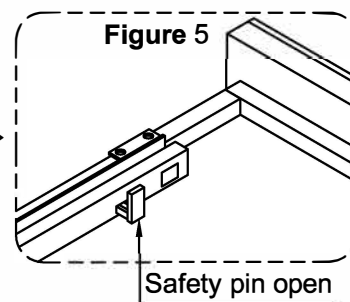
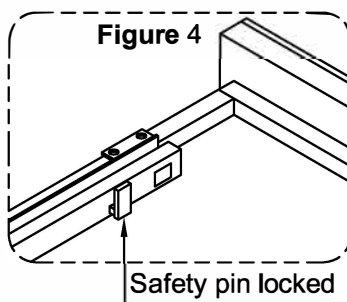
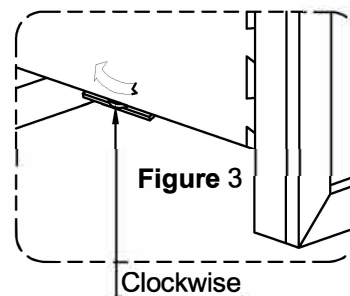
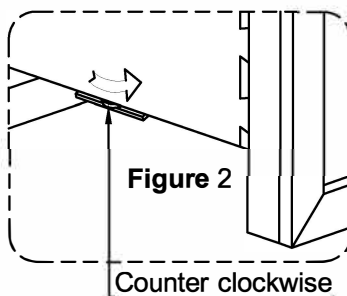
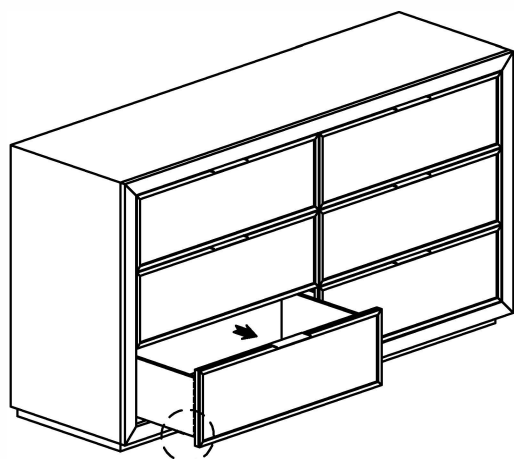

## CARE INSTRUCTIONS

- To avoid scratches, do not place sharp or jagged objects directly on the top.
- Do not place hot items directly on the top.
- Use placemats or trivets under hot items and coasters under beverages to prevent marks and stains.
- Avoid the use of harsh chemicals or abrasive cleaning materials.
- Wipe the table clean with a soft, dry cloth after each use.
- Wipe up spills quickly with a soft, dry cloth.

Flexsteel Industries, Inc.

For Parts or Customer Service call

toll-free:

1-888-415-3979

Monday-Friday

8:00 a.m. - 5:00 p.m.

(Central Time)

Email:

customersolutions@flexsteel.com

www.flexsteel.com