

## Features

- Solid brass construction
- Single-post, open roller design
- Complements Empire product series

## Codes / Standards Compliance

Meets or exceeds the following at date of manufacture:

- All applicable US Federal and State material regulations

## Colors / Finishes

- PC: Polished Chrome
- PN: Polished Nickel
- SN: Satin Nickel



## Specified Model

Model	Description	Colors   Finishes
609	Open Toilet Tissue Holder	<input type="checkbox"/> PC <input type="checkbox"/> PN <input type="checkbox"/> SN

## Product Specification: Add "Color / Finish" Suffix to Model Number Below

The Toilet Tissue Holder shall be made of solid brass construction and incorporate a single-post, open roller design. Toilet Tissue Holder shall complement Ginger Empire product series. Toilet Tissue Holder shall be Ginger Model 609/\_\_\_\_\_.

# 609

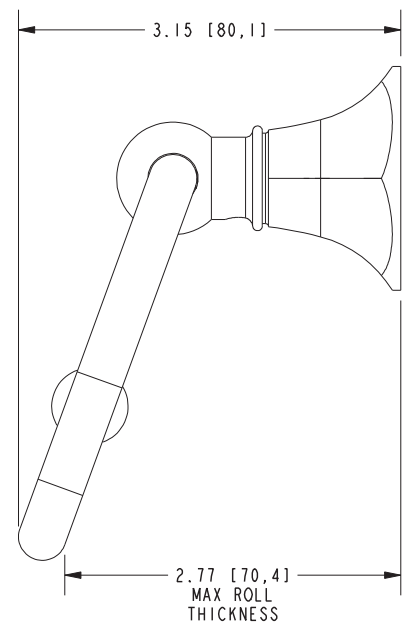
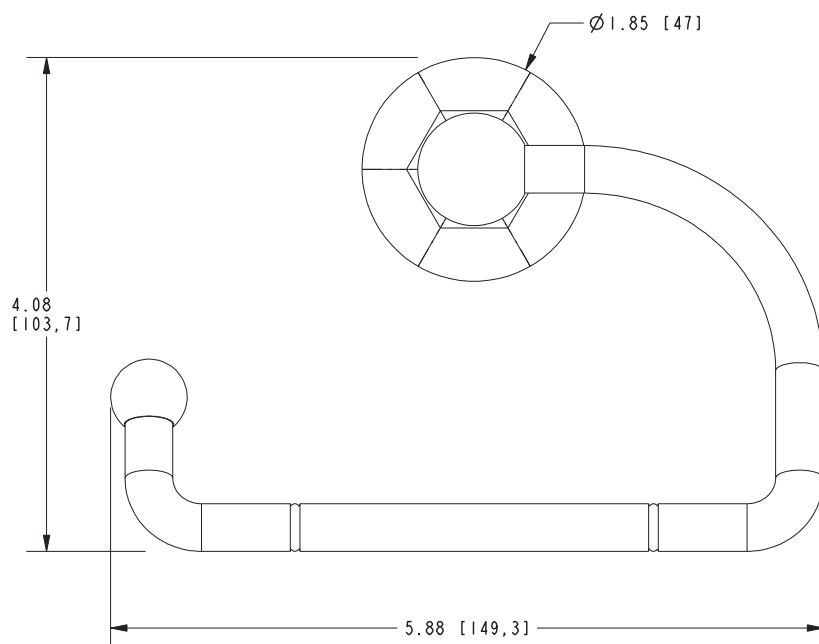

## Empire Toilet Tissue Holder 609

Page 2 of 2 Spec\_609\_c\_2.22  
EN-4358

# GINGER

t: 949.417.5207 | [www.gingerco.com](http://www.gingerco.com)  
©2022 Brasstech, Inc.