

9610-K10, 9610-K30 9610-K50, 9610-K80, & 9610-K90 Air Switch for Waste Disposal Installation Instructions

CALIFORNIA FAUCETS RECOMMENDS THAT ALL PLUMBING & ELECTRICAL PRODUCTS BE INSTALLED BY A LICENSED PROFESSIONAL

IMPORTANT: Read all instructions prior to installation and provide copy of instructions to consumer.

Operating Specifications:

Recommended Electrical Supply Outlet Rating: 120V AC @ 15A Min.†

Controller Outlet Output Rating: 120V AC @ 13A (non-inductive) or 1/2 HP (.373 kW) @ 120V AC

† Local codes and ordinances may require a GROUND-FAULT CURRENT INTERRUPTER (GFCI) type.

I INSTALLING TO SINK/DECK/CABINET

IMPORTANT: Determine location of AIR SWITCH (1). Unit may be mounted on sink, deck or cabinet face. The recommended sink/deck/cabinet through-hole shall be $\varnothing 1\text{-}1/4"$ [32mm]. Maximum sink/deck/cabinet thickness should no greater than 2-3/8" [30mm]

- Place AIR SWITCH (1) through sink/deck/cabinet hole
- From underside or backside slide WASHER (2) and NUT (3) onto SHANK (1a); securely tighten NUT (3)

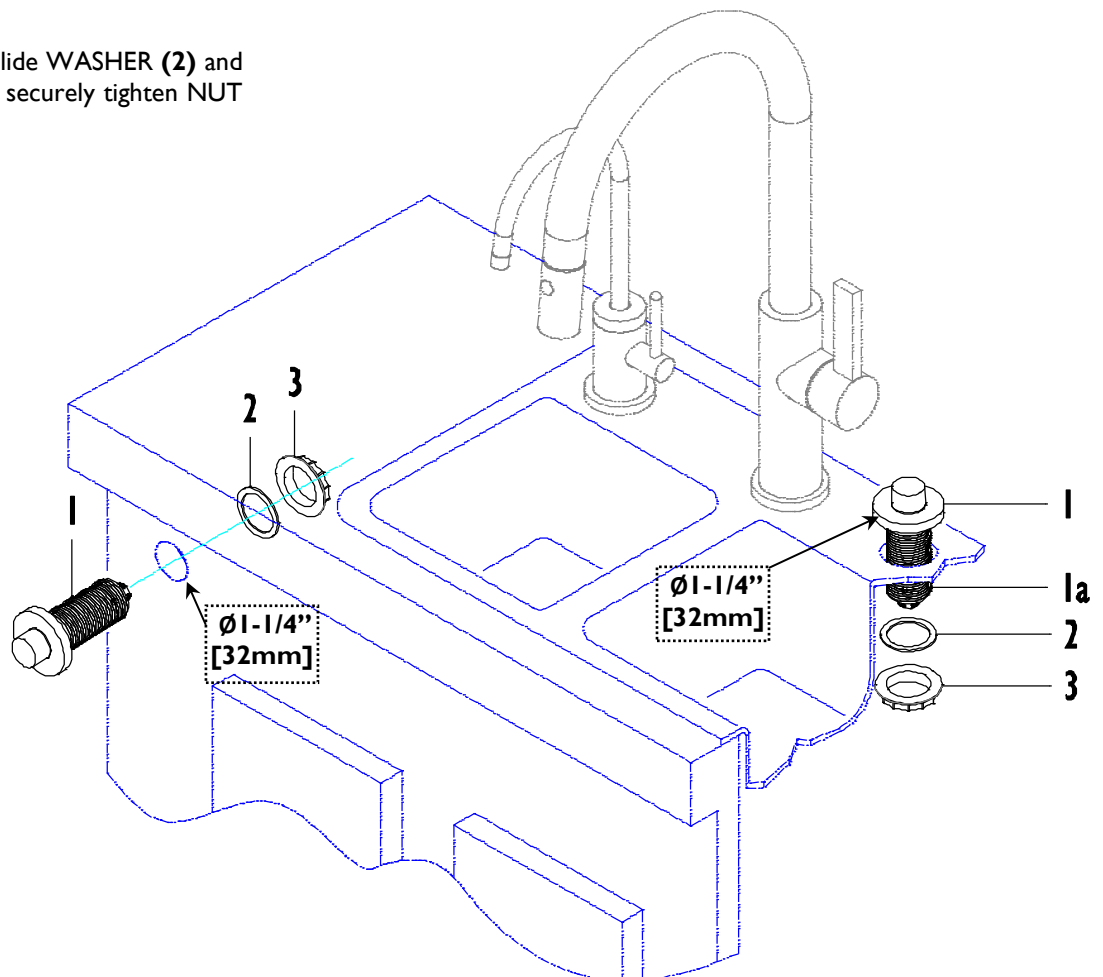

MOUNTING CONTROLLER

IMPORTANT: Determine location of **CONTROLLER (4)**. The location should be near the electrical **OUTLET (7)** and **DISPOSAL CORD (8a)**

- Mount **CONTROLLER (4)** to side or back wall under sink with two **SCREWS (5)** (not supplied)
- Slide **TUBE (6)** onto air switch **OUTLET (1d)** and the other end to controller **INLET (4a)**
- Insert **CONTROLLER CORD (4b)** into three-prong grounded **RECEPTACLE (7)**

NOTE: Three-prong grounded receptacle shall be in accordance with all local electrical codes and ordinances

NOTE: Some local codes may require a GFCI-protected receptacle

WARNING: When **DISPOSAL CORD (8a)** is plugged into **CONTROLLER OUTLET (4c)** the **DISPOSAL (8)** may turn on; to turn off **DISPOSAL (8)** press **AIR SWITCH (1)**

- Insert **DISPOSAL CORD (8a)** into one of the two **CONTROLLER OUTLET (4c)**

NOTE: The other **CONTROLLER OUTLET (4d)** may be used for other device (e.g. instant hot water tank); **DO NOT** use for dishwasher as this outlet switches OFF when **DISPOSAL (8)** is in use

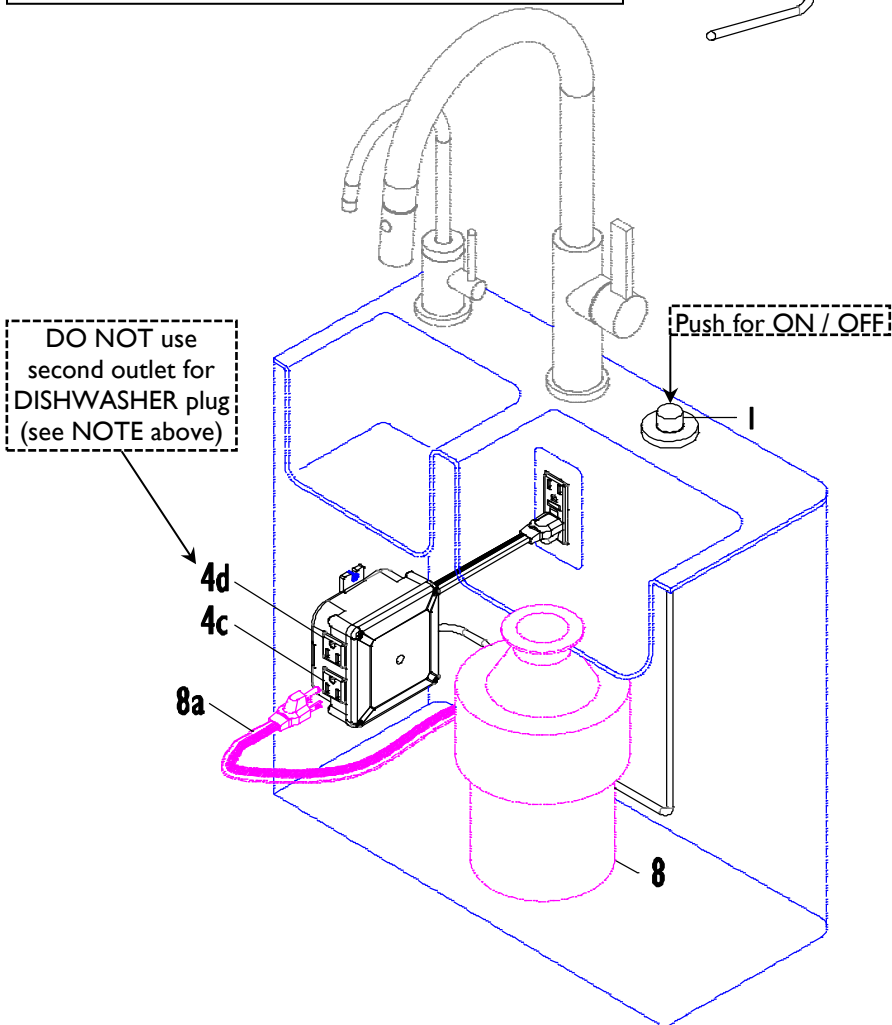
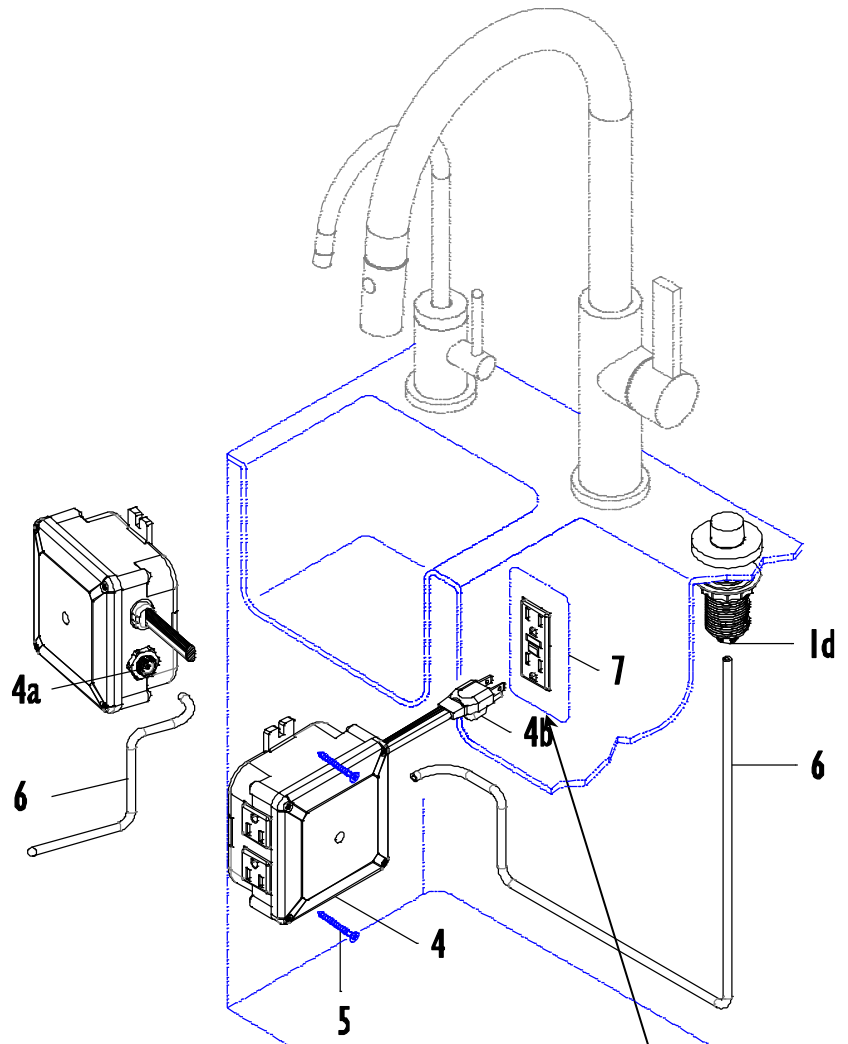

**THREE-PRONG
GROUNDED RECEPTACLE
15A MIN**
Follow all local electrical codes &
ordinances as some may require
GFCI-protected receptacle