

Table of Contents

1	Installation	12
1.1	Positioning in the counter top	12
1.2	Mounting	15
1.3	Gas supply requirements	16
1.4	Electrical requirements	25
1.5	For the installer	26

IMPORTANT SAFETY INSTRUCTIONS



WARNING

If the instructions contained in this manual are not followed precisely, a fire or explosion may result causing property damage, personal injury or loss of life.

Do not store or use gasoline or other flammable vapors, liquids or materials near this or any other appliance.

- WHAT TO DO IF YOU SMELL GAS

- Do not try to light any appliance.
- Do not touch any electrical switch.
- Do not use any telephones in your building.
- Immediately call your gas supplier from a neighbor's phone. Follow the gas supplier's instructions.
- If you cannot reach your gas supplier, call the fire department.

- Installation and service must be performed by a qualified installer, service company or gas supplier.

INSTALLATION AND SERVICE MUST BE PERFORMED BY A QUALIFIED INSTALLER.

IMPORTANT: SAVE FOR THE LOCAL INSPECTOR'S USE.



Important Safety Instructions

WARNING



- This appliance is intended for residential use only.
- Use this appliance only for its intended purpose. The manufacturer cannot be held liable for damage caused by improper use of this appliance.
- This appliance complies with current safety regulations. Improper use of this appliance can result in personal injury and property damage.
- Read all the instructions before installing or using the appliance for the first time.
- Keep these operating instructions in a safe place and give them to any future user.

The safety messages will inform you of potential hazards, on how to avoid the risk of injury and what can occur if the instructions are not followed.

IMPORTANT: Installation, gas connections and grounding must comply with applicable codes. Observe all codes and ordinances in force.



NOTE: This appliance is designed for use with natural gas. To convert the appliance to LPG/Propane gas, see the instructions in the "Conversion to propane gas (LPG)" section.

The proper gas supply connection must be available. See "Gas supply requirements".

WARNING: For your safety, the instructions contained in this manual must be followed to minimize the risk of fire or explosion and to prevent property damage, personal injury or loss of life.

Important Safety Instructions



NOTE: This appliance is NOT designed for installation in manufactured (mobile) homes or in recreational vehicles (RVs).

DO NOT install this appliance outdoors. Improper installation is not covered by the warranty.

NE

WARNING



- Failure to follow the instructions in this manual may result in fire or electric shock, causing property damage or personal injury.
- Do not repair, replace or remove any part of the appliance unless specifically recommended in the manuals. Improper installation, service or maintenance can cause injury or property damage. Refer to this manual for guidance. All other servicing should be carried out by an authorized servicer.
- To reduce the risk of fire, electric shock, personal injury or damage when using the appliance, follow basic safety precautions, including the following.

Important Notes to the Installer

- Read all the instructions contained in this manual before installing the appliance.
- Remove all packing material from the appliance before connecting the electrical and gas supplies to the appliance.
- Observe all governing codes and ordinances. Be sure to leave these instructions with the consumer.

- It is the responsibility of the installer to comply with installation information specified on the model/serial ID plate. The ID plates are located in a visible position on the back of the appliance. These ID plates must never be removed.

Important Note to the Customer

- Keep these instructions with your owner's guide for future reference.
- Any additions, changes or conversions required for this appliance to satisfactorily meet the application requirements must be made by a qualified technician.



Important Safety Instructions

Definitions

- This manual contains important safety symbols and instructions. Please pay attention to these symbols and follow all instructions given.



WARNING

This symbol will help alert you to situations that may cause serious bodily harm, death or property damage.



CAUTION

This symbol will help alert you to situations that may cause injury or property damage.

Appliance Handling Safety

Hidden surfaces may have sharp edges. Use caution when reaching behind or under the appliance.

- Wear gloves to avoid cutting fingers on sharp edges during installation.
- The unit is heavy and requires at least two persons or proper equipment to move it.

Safety Codes and Standards

This appliance complies with one or more of the following Standards:

ANSI Z21.1/CSA 1.1 Household Cooking Gas Appliances

- It is the responsibility of the owner and the installer to determine whether additional requirements and/or standards apply to specific installations.
- Installation must conform with local codes or, in the absence of local codes, with the National Fuel Gas Code, ANSI Z223.1/NFPA 54 or, in Canada, the Natural Gas and Propane Installation Code, CSA B149.1.
- The appliance must be electrically grounded in accordance with local codes or, in the absence of local codes, with the National Electrical Code, NFPA 70 latest edition or, in Canada, the Canadian Electric Code, CSA C22.1-02.
- Ensure that the electrical system is adequate and in compliance with the national ANSI / NFPA 70 ELECTRICAL CODE – latest edition – or the CANADIAN ELECTRICAL CODE, C22.11 – 1 and C22.2 No. 01982 – or latest edition – and all local codes and ordinances. **IMPORTANT:** Observe all codes and ordinances in force.
- Proper installation is your responsibility.

Important Safety Instructions



- Make sure your appliance is installed and grounded properly by a qualified installer or service technician.
- Make sure that the wall coverings around the appliance can withstand the heat generated by the appliance.



WARNING

Never leave children alone or unattended in the area where an appliance is in use. As children grow, teach them the proper, safe use of all appliances.

- Test the appliance immediately after installation, following the instructions in this booklet. If the appliance does not work properly, disconnect it from the electrical power supply and call the service center. **DO NOT** attempt to repair the appliance.
- All adjustments and servicing must be performed by qualified installers or service technicians.
- Do not leave the packing materials around the home. Sort the various items of waste and take them to the nearest specialized waste collection facility.
- Do not store items of interest to children in the cabinets above the appliance. Children could be seriously burned if they climb on the appliance to reach items.

- To eliminate the need to reach over the surface burners, cabinet storage space above the burners should be avoided.
- Do not store or use gasoline or other flammable vapors and liquids near this or any other appliance. Explosions or fires could result.
- Adjust the size of the surface burner flame so that it does not extend beyond the edge of the pan. An excessively large flame is hazardous.
- Do not use the appliance for warming or heating the room. Prolonged use without adequate ventilation can be dangerous.
- In the event of an electrical power outage, the surface burners can be lit manually. To light a surface burner, hold a lit match to the burner head and slowly turn the Surface Control knob to LITE. Use caution when lighting surface burners manually.
- **THIS COOKTOP IS NOT REMOVABLE.** Do not attempt to remove the cooktop.



WARNING

Do not repair, replace or remove any part of the appliance unless specifically recommended in the manuals. Improper installation, service or maintenance can cause injury or property damage. Refer to this manual for guidance. All other servicing should be done by an authorized service provider.



Important Safety Instructions

Electric Safety



WARNING

Before you plug the electrical cord into an outlet, make sure that all the appliance controls are in the OFF position.



WARNING

Disconnect the power supply before servicing the appliance.

- Personal injury or death from electrical shock may occur if the appliance is not installed by a qualified installer or electrician.
- Make sure your appliance is properly installed and grounded by a qualified electrician. Installation, electrical connections and grounding must comply with all applicable codes.
- Switch OFF the power at the service panel before installation. Lock the service panel to prevent the power from being switched ON accidentally.
- For appliances equipped with a cord and plug, do not cut or remove the ground prong. It must be plugged into a matching grounding type receptacle to avoid electrical shock. If there is any doubt as to whether the wall receptacle is properly grounded, the customer should have it checked by a qualified electrician.
- Do not use an extension cord.
- Do not use an adapter.

- If required by the National Electrical Code (or Canadian Electrical Code), this appliance must be installed on a separate branch circuit.
- The circuit breaker should have a contact separation of at least 3 mm on all poles.
- INSTALLER – show the owner the location of the circuit breaker or fuse. Mark it for easy reference.
- Refer to rating label for more information.

Gas safety



WARNING

Burning gas cooking fuel generates some by-products which are on the list of substances which are known by the State of California to cause cancer or reproductive harm. To minimize exposure to these substances, always operate this unit according to the instructions contained in this booklet and provide good ventilation.

- Install a gas shutoff valve near the appliance. It must be easily accessible in an emergency.
- Leak testing must be conducted by the installer according to the instructions in this manual.
- The appliance and its individual shutoff valve must be disconnected from the gas supply piping system during any pressure testing at pressures in excess of ½ psi (3.5 kPa).

Important Safety Instructions



- The appliance must be isolated from the gas supply piping system by turning off its individual manual shutoff valve during pressure testing of the gas supply piping system at test pressures equal to or less than ½ psi (3.5 kPa).
- The minimum supply pressure must be 1" water column above the manifold pressure printed on the rating label. The maximum supply pressure of 14.0 inches water column (34.9 Millibars) must not exceed.
- **IMPORTANT SAFETY NOTICE** Burning gas cooking fuel generates some by products which are on the list of substances which are known by the State of California to cause cancer or reproductive harm. To minimize exposure to these substances, always operate this unit according to the instructions contained in this booklet and provide good ventilation.

Proposition 65 Warning:

This product may contain a chemical known to the State of California, which can cause cancer or reproductive harm. Therefore, the packaging of your product may bear the following label as required by California:

State of California Proposition 65



WARNING

Cancer or Reproductive Harm -
www.P65Warnings.ca.gov

Propane Gas Installation

- The propane gas tank must be equipped with its own high pressure regulator. In addition, the regulator supplied with this unit must also be used.
- The appliance is shipped from the factory for use with natural gas. It must be converted for use with propane. The conversion must be done by a qualified technician or installer.
- This appliance can operate up to an altitude of 10,000 ft. (3048 m.) elevation above sea level. For use with propane gas, the appliance must be converted in accordance with the propane conversion instructions.

For installations in Massachusetts

- Installation must be performed by a qualified or licensed contractor, plumber or gas fitter qualified or licensed by the state, province or region where this appliance is being installed.
- Shut-off valve must be a "T" handle gas cock.
- Flexible gas connector must not be longer than 36 inches.
- Installer - show the owner where the gas shut-off valve is located.



Important Safety Instructions

Related Equipment Safety

- The appliance should only be used if installed by a qualified technician in accordance with these installation instructions and all applicable regulations and codes. The manufacturer is not responsible for damages resulting from incorrect installation.
- Remove all tape and packaging before using the appliance. Dispose of the packaging after unpacking the appliance. Never allow children to play with packaging material.
- Never modify or alter the construction of the appliance. For example, do not remove leveling legs, panels, wire covers or anti-tip brackets/screws.
- To eliminate the risk of burns or fire by reaching over hot surface units, cabinet storage space located above the surface units should be avoided. If cabinet storage is to be provided, the risk can be reduced by installing a hood that projects horizontally a minimum of 5 inches (127 mm) beyond the bottom of the cabinet. Be sure cabinets above the cooktop are a maximum of 13" (330 mm) deep.
- When installing a cooktop over a single oven, be sure to follow both the oven and cooktop installation manuals.

Ventilation Recommendations

- Do not obstruct air vents or heat vent openings.
- We strongly recommend the installation of a ventilation hood above this appliance. The hood must be installed according to the instructions provided with the hood.
- Do not obstruct the flow of combustion air at the oven vent or around the base or under the lower front panel of the appliance. Avoid touching the vent openings or nearby surfaces as they may become hot while the oven is in operation. This appliance requires fresh air for proper burner combustion.
- Air curtains or other overhead range hoods that work by blowing air downwards onto the appliance, must not be used in conjunction with gas appliances unless the hood and the appliance have been designed, tested and listed by an independent test laboratory for use in combination with each other.



CAUTION

The appliance should not be installed with a ventilation system that blows air downward toward the burners. This type of ventilation system may cause ignition and combustion problems with the gas cooking appliance and may result in personal injury or unintended operation.



High altitude installation

- This appliance can operate up to an altitude of 10,000 ft. (3048 m.) elevation above sea level. If desired, for altitudes above 2,000 ft (610 m) elevation above sea level, adjustments may be made.
- Burners should be checked at the lowest setting, if the flame is not stable, the simmer should be increased until the flame is stable. This can be done by adjusting the bypass screw in the valve. If flame performance is satisfactory, adjustment will not be required.
- It is required that a Certified Professional make the high altitude adjustments during installation.



WARNING

Failure to follow the instructions in this manual may result in fire or electric shock, causing property damage or personal injury.

- Improper installation is not covered by the warranty.

How to read the user manual

This user manual uses the following reading conventions:

Installation



Information for the qualified technician: installation, operation and inspection.



Safety instructions



Advice/Information

1. Use instruction sequence.
- Single use instructions.

SAVE THESE INSTRUCTIONS



Installation

1 Installation

Safety instructions



WARNING

Risk of fire

- Make sure that the cabinet material is heat resistant.
- Check that the cabinet has the required openings.

Veneers, adhesives or plastic coatings on adjacent units should be temperature-resistant ($>194^{\circ}\text{F}/>90^{\circ}\text{C}$), otherwise they might warp over time.



NOTE: The minimum distance between a range hood and the cooktop must be at least the distance specified in the range hood installation instructions.

The minimum clearances must also be complied with regarding the back edge of the cooktop as indicated in the installation illustrations.

1.1 Positioning in the counter top



NOTE: The following operation requires construction and/or carpentry work and must therefore be carried out by a competent technician.

The cooktop may be installed on a variety of materials, such as masonry, metal, solid wood or plastic laminated wood, as long as they are heat resistant ($>194^{\circ}\text{F}/>90^{\circ}\text{C}$).

Fixing to the traditional built-in model support structure

Make a hole in the countertop of the furniture unit of the dimensions shown in the figure.

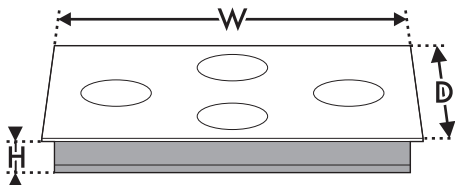

24" models:

	mm	inches
W	617	$24 \frac{5}{16}$
D	509	20
H	88	$3 \frac{7}{16}$

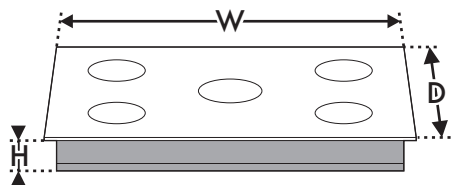

30" models:

	mm	inches
W	760	$29 \frac{15}{16}$
D	533	$20 \frac{15}{16}$
H	78	$3 \frac{1}{2}$

36" models:

	mm	inches
W	866	$34 \frac{7}{64}$
D	511	$20 \frac{1}{8}$
H	69	$2 \frac{23}{32}$

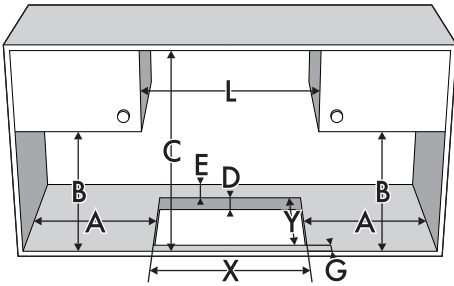

24" models:

	mm	inches
A	152	6
B	460	18 ¹ / ₈
C	750	29 ⁹ / ₁₆
D	20 - 50	³ / ₄ - 1 ¹⁵ / ₁₆
E	51	2
G	min. 25	min. 1
X	592	23 ⁵ / ₁₆
Y	488	19 ¹ / ₄

30" models:

	mm	inches
A	700	27 ⁹ / ₁₆
B	457	19 ³ / ₈
C	762	30
D	50	2
E	50	2
G	50	2
X	700	27 ⁹ / ₁₆
Y	492	19 ³ / ₈

36" models:

	mm	inches
A	210	8 ¹ / ₄
B	457	18
C	762	30
D	50	2
E	50	2

G	50	2
X	847	23 ³ / ₈
Y	482	19

Location of the gas and electric outlets

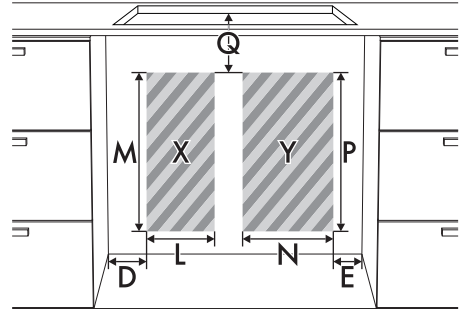

	mm	inches
L	150 mm	6"
M	762 mm	30"
N	260 mm	10"
P	762 mm	30"
Q	25 mm	1"
D	76 mm	3"
E	38 mm	1 ¹ / ₂ "

X = Grounded outlet

Y = Gas supply line

*If there is a piece of furniture above the cooktop. In the case of hood, refer to the values in the relevant manual.

To prevent liquids from leaking between the frame of the cooktop and the countertop, fit the insulating seal provided before assembly.



Installation

1. Refer to the dimensions in the figure, making sure that the front and rear long sides are flush with the hole.

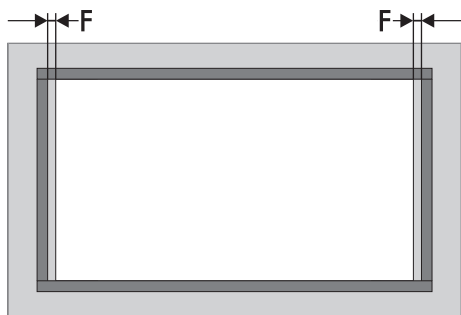

	mm	inches
F	3 - 4	$1/8 - 3/16$

2. Press lightly to make the seal adhere to the edge around the hole in the countertop. The front and rear sides of the seal must be flush with the hole.
3. Place the cooktop on the insulating seal and fix it to the support structure using the screws and fastening brackets supplied (A) so that the cooktop is perfectly level.

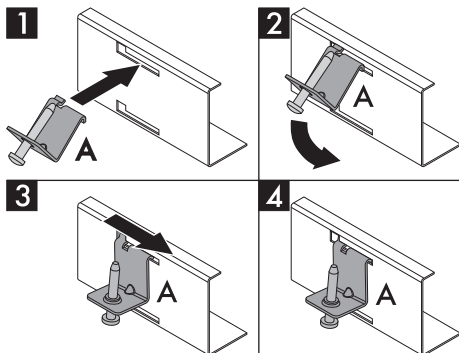

4. Carefully trim any excess material away from the edge (B) of the seal.

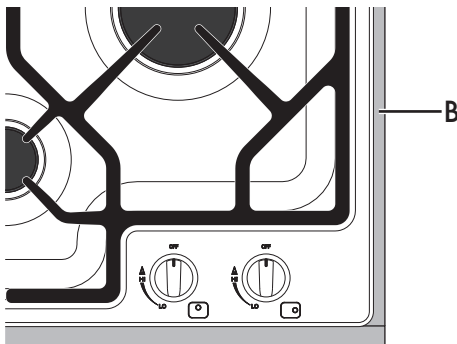

NOTE: The brackets should only be positioned after the cooktop has been placed on the seal.

Overall dimensions:: gas and electrical connection points

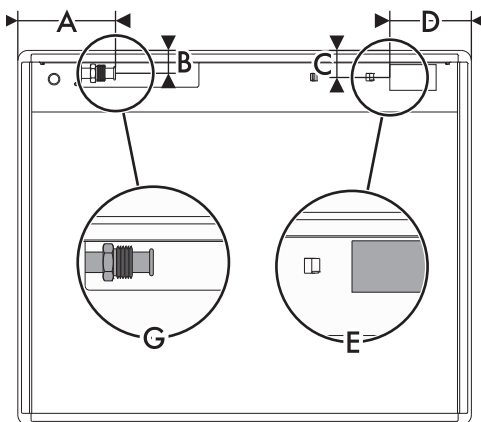

View from the bottom

G = Gas pipe connection

E = Electrical connection



24" models:

	mm	inches
A	132	5 ³ / ₁₆
B	29.7	1 ³ / ₁₆
C	38.5	1 ⁹ / ₁₆
D	115	4 ⁹ / ₁₆

30" models:

	mm	inches
A	270	10 ⁵ / ₈
B	45	1 ³ / ₄
C	50	2
D	150	5 ¹⁵ / ₁₆

36" models:

	mm	inches
A	290	11 ⁷ / ₁₆
B	50	2
C	50	2
D	170	6 ¹¹ / ₁₆

1.2 Mounting

Over built-in oven unit

The clearance between the cooktop and the kitchen furniture or other installed appliances must be enough to ensure sufficient ventilation and air discharge.

If installed above an oven, a space should be left between the bottom of the cooktop and the top of the appliance installed below.

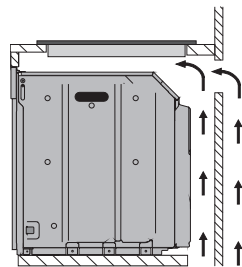
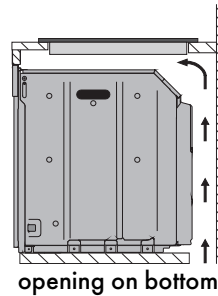

NOTE: If installed above of an oven, the latter must be fitted with a cooling fan.



Installation

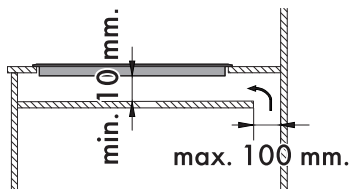

opening at rear

On top of empty kitchen unit or drawers

If there are other pieces of furniture (side walls, drawers, etc.), dishwashers or refrigerators under the cooktop, a double-layer wooden base must be installed at least **10 mm** from the bottom of the cooktop to prevent accidental contact. It must be possible to remove the double-layer base only with the aid of suitable tools.

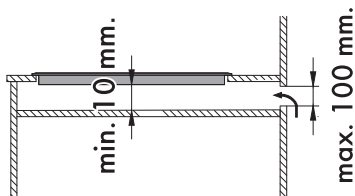
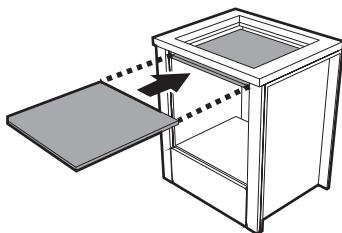

opening on bottom



Failure to install the double-layer wooden base exposes the user to possible accidental contact with sharp or hot parts.

1.3 Gas supply requirements



WARNING

Explosion hazard

- Use a new AGA or CSA-certified connector.
- Install a manual shut-off valve.
- Securely tighten all gas connections.
- If connected to LPG, have a qualified technician ensure that the gas pressure does not exceed a 14" W.C.P.
- Examples of qualified technicians include licensed heating personnel, authorized gas company personnel, and authorized service personnel.
- Failure to do so can result in loss of life, explosion, or fire.



NOTE:

- Observe all codes and ordinances in force.
- The appliance must be connected to a standard gas supply.

This installation must conform with all local codes and ordinances. In the absence of local codes, installation must conform to the American National Fuel Gas Code, ANSI Z223.1/NFPA 54 or, in Canada, the Natural Gas and Propane Installation Code, CSA B149.1.

If local codes permit, a flexible metal appliance connector with the new AGA or CSA certified design, 4-5 feet (1.2-1.5 m) long, $\frac{1}{2}$ " or $\frac{3}{4}$ " ID NPT, is recommended for connecting this appliance to the gas supply line.



Do not bend or damage the flexible connector when moving the appliance. The pressure regulator has 3/8" female pipe threads. You will need to determine the fittings required, depending on the dimension of your gas supply line, the flexible metal connector and the shut-off valve. The appliance should be installed in rooms that have a permanent air supply in accordance with the applicable standards. The room in which the appliance is installed must have sufficient airflow to ensure proper combustion of the gas and the necessary air exchange in the room itself. The air vents, protected by grilles, must be of the correct size to comply with current regulations and positioned so that no part of them is obstructed, even partially. The room must be sufficiently ventilated to remove the heat and humidity generated during cooking: it is advisable to open a window or increase the speed of any fans, especially after long periods of use.

Gas connection

The appliance is shipped from the factory for use with natural gas at a pressure of 4" of water column. When checking if the regulator is working properly, the inlet pressure must be at least 1" greater than the operating (manifold) pressure above. When used with natural gas, the pressure supplied to the regulator must be between 5" and 10.5" of the water column. To convert the appliance for use with propane, see "Conversion to propane gas (LPG)". The conversion must be done by a qualified technician or installer. The gas inlet to the unit is located at the back right of the appliance. Install the pressure regulator (supplied with the unit) on the gas inlet.

Place the gasket (supplied with the unit) between the inlet and the regulator. Position the regulator so that the cap is easily accessible. Tighten the nut on the gas inlet so that it is hand tight plus 1/3 turn. Connect the gas pipe to the regulator using Teflon tape or pipe joint compound (resistant to propane gas and natural gas). Turn so that it is hand tight plus 1/3 turn. Do not exceed 1 turn for alignment, to prevent possible damage to the gas pressure regulator. Check the inlet connections and the regulator for leaks.

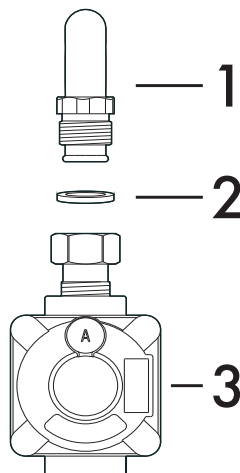

- 1 - Gas inlet (attached to the appliance)
- 2 - Gasket
- 3 - Pressure regulator

WARNING: Do not attempt to adjust the pressure regulator, except when converting to propane. Adjustments could lead to leaks or cause incorrect gas pressure being supplied to the appliance.



Installation

Testing for gas leaks

WARNING



FIRE HAZARD
Use a soapy solution to check for leaks.
Never use a match or an open flame to test for gas leaks.
Failure to follow these instructions could result in loss of life or fire.

Follow these instructions to test the appliance for leaks:

Use a brush and liquid detergent to check all gas connections for leaks. Bubbles around connections indicate a leak. If a leak is found, shut off the gas valve controls and tighten the connections. Then check the connections again.

Wipe off any detergent from the appliance. Replace the parts on the burner and turn the knobs on the gas tap valves.

NEVER USE A MATCH OR AN OPEN FLAME TO TEST FOR GAS LEAKS.

Check the appearance of the flames

- Yellow flames: Further adjustment is required.
- Yellow tips on outer cones: Normal for LPG.
- Soft blue flames: Normal for Natural Gas.
- Orange flames: Can be normal if certain types of humidifiers are used in the home. Flames should return to blue without the humidifier running.

If the flame is completely or mostly yellow, verify that the regulator is set for the correct fuel. Retest after adjustment.

Some yellow streaking is normal during the initial startup. Allow the appliance to operate for 4–5 minutes and reevaluate before making adjustments.

Shut-off valve

The supply line must be fitted with an approved shut-off valve. This valve should be in the same room as the appliance and in a position where it is easy to open and close. Do not block access to the shut-off valve. The valve is necessary for turning the gas to the appliance on or off.

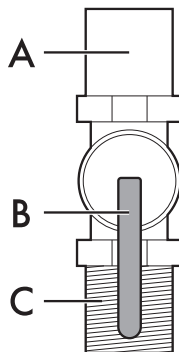

A - To appliance

B - Shutoff valve "open" position

C - Gas supply line



Burner and nozzle characteristics tables

To set the range for propane gas or to revert to Natural Gas, refer to the tables below.

For 24" models:

Natural Gas	AUX	RR	UR3
QT (BTU)	3600	9100	12000
Injector Ø (mm)	0.90	1.40	1.65
QR (BTU)	1200	2500	4200
Propane	AUX	RR	UR3
QT (BTU)	3600	9100	12000
Injector Ø (mm)	0.54	0.88	1.02
QR (BTU)	1200	2500	4200
By-pass (mm)	0.32	0.42	0.63

For 30" and 36" models:

Natural Gas	AUX	SR	UR3
QT (BTU)	3400	6200	13000
Injector Ø (mm)	0.90	1.20	1.75
QR (BTU)	1200	1600	4200
Propane	AUX	SR	UR3
QT (BTU)	3400	6200	13000
Injector Ø (mm)	0.54	0.72	1.02
QR (BTU)	1200	1600	4200
By-pass (mm)	0.32	0.38	0.63



NOTE: Keep the nozzles that were removed from the appliance along with these instructions for possible future use.



Installation

- Connect the gas supply line to the pressure regulator using a 1/2" flex gas line connector between the manual shut-off valve and the pressure regulator. A metal flex line or fixed metal pipe must be used to connect the gas to the appliance. If a metal gas line cannot be used, consult your local certified electrician or local electric codes for proper grounding.
- Check the supply line connections for leaks using a soap solution or non-corrosive leak detection fluid. Do not use a flame of any sort.

Important notes for Gas Connection

- The appliance and its individual gas shutoff valve must be disconnected from the gas supply piping system during pressure testing of the system at test pressures in excess of 1/2 psi (3.5 kPa).
- The appliance must be isolated from the gas supply piping system by closing its manual shut-off valve during the pressure testing of the gas supply piping system at test pressures equal to or less than 1/2 psi (3.5 kPa).

Final operations

- Complete the Gas Conversion label (part no. 92849A078) and attach it to the rear of the appliance. Do not cover any other labels with the Gas Conversion label.

- Over time, the gas taps may become difficult to turn and jam. Clean them internally and replace the lubrication grease.



NOTE: The gas taps should be lubricated by a qualified technician.

- Keep the nozzles that were removed from the appliance together with these instructions for possible future use.
- For installation of the appliance at high altitude, please consult your local gas company for their recommendation on the correct orifice sizes and any other necessary adjustments that will provide proper gas combustion at specified altitudes.

Inlet pressure

To check the regulator, the incoming line pressure upstream of the regulator must be 1" (2.5 cm) W.C.P. higher than the manifold pressure. Incoming line pressure to the regulator should be as follows for operation and checking the regulator setting:

- **Natural Gas:** Set pressure to 4" W.C.P. Inlet pressure from 5" - 10 1/2" W.C.P. maximum.
- **LP Gas:** Set pressure to 11" W.C.P. Inlet pressure from 12"- 13" W.C.P. maximum.



Conversion to propane gas (LPG)



WARNING

This conversion kit must be installed by a qualified service agency in accordance with the manufacturer's instructions and all applicable codes and regulations of the authority having jurisdiction. If the information in these instructions is not followed exactly, a fire, explosion or production of carbon monoxide may result causing property damage, personal injury or loss of life. The professional installation service is responsible for the correct installation of this kit. The installation is not proper and complete until the operation of the converted appliance is checked as specified in the manufacturer's instructions supplied with the kit.



WARNING

Before proceeding with the gas conversion, the gas supply must be turned off before disconnecting the electrical power.



WARNING

A gas leak test should be performed after the gas conversion has been carried out.

Always provide an adequate gas supply.

This appliance is shipped from the factory for use with natural gas. Use this kit to convert the appliance for use with propane gas, if necessary. Comply with the following: Ensure that the range is converted for use with the appropriate gas before using it.

This appliance is designed to operate at a pressure of 11" of water column when used with propane gas. When checking if the regulator is working properly, the inlet pressure must be at least 1" greater than the operating (manifold) pressure above.

When converting for propane gas use, the pressure supplied to the regulator must be between 12" and 13" of the water column. The pressure regulator located at the inlet of the range manifold must remain in the supply line.

Use a flexible metal appliance connector or rigid pipe to connect the range to the gas supply. The connector should have an inside diameter of 1/2" and be 5 ft (1.5 m) or less in length.

(Exception: Maximum connector length in Massachusetts installations is 3 ft (0.9 m). In Canada, the connector must be single-wall metal and not longer than 6 ft (1.8 m).

Keep the nozzles removed from the appliance for future use.



CAUTION

Before proceeding with the gas conversion, the gas supply must be turned off before disconnecting the electrical power.



Installation

Setting the pressure regulator for propane gas

To convert the regulator to the type of gas used, the following must be done:

1. Unscrew the cover of the pressure regulator.

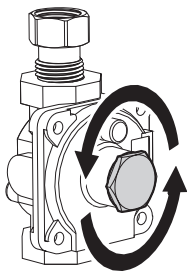

2. Unscrew the plastic regulator stem from the regulator cap. Configuration "A" is for Natural Gas.
3. Invert the plastic regulator stem to achieve the configuration "B" for Propane Gas and screw it in tightly.

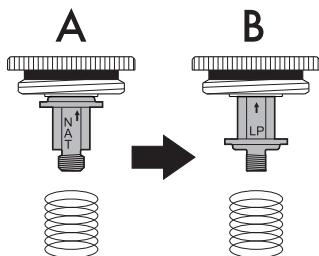

4. Screw the regulator stem and cap into place.

Conversion kit parts list

This conversion kit consists of the following components:

- One Gas Conversion label.
- One gasket 12.5x18.5x2 (mm) - 0.5x0.73x0.08 (in).
- One label for LPG injectors.

For 24" models:

- Two injectors Ø 0.54 mm for the Auxiliary burner.
- One injector Ø 0.88 mm for the Reduced Rapid burner.
- One injector Ø 1.02 mm for the Ultra-rapid triple crown burner.

For 30" models:

- Two injectors Ø 0.54 mm for the Auxiliary burner.
- Two injectors Ø 0.72 mm for the Semi-rapid burners.
- One injector Ø 1.02 mm for the Ultra-rapid triple crown burner

For 36" models:

- One injector Ø 0.54 mm for the Auxiliary burner.
- Three injectors Ø 0.72 mm for the Semi-rapid burners
- One injector Ø 1.02 mm for the Ultra-rapid triple crown burner.



Replacing the burner nozzles

1. Remove the components from the cooktop.

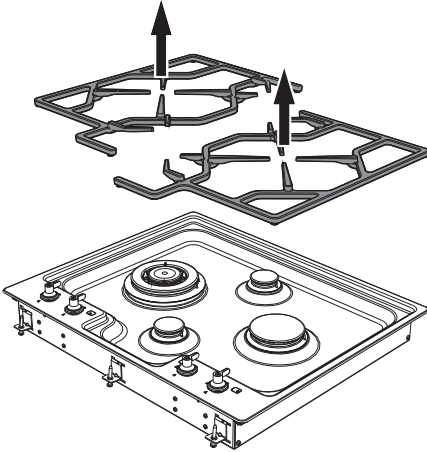

2. Remove the flame-spreader crowns and corresponding burner caps.

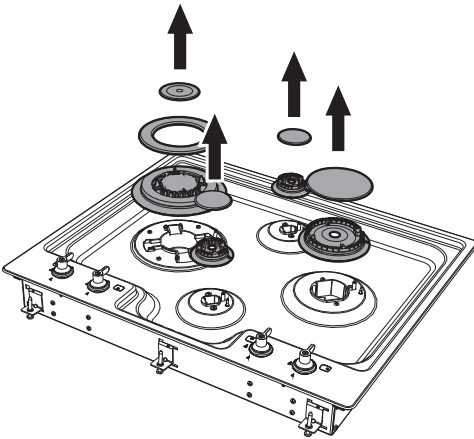

3. Replace the burner nozzles using a 7 mm socket wrench according to the type of gas to be used (see "Burner and nozzle characteristics tables").

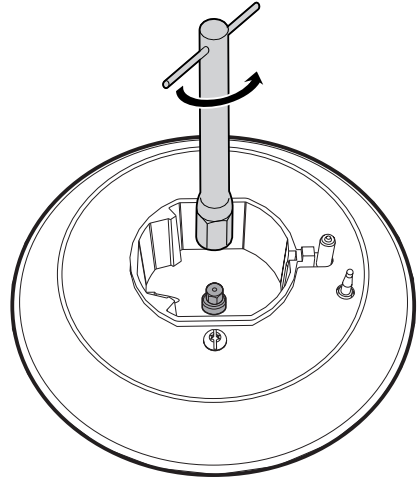

4. Replace the burners in their respective housings.



NOTE: The tightening torque of the nozzles must not exceed 3 Nm.



NOTE: There are no burner parts under the cooktop to clean, disassemble or adjust.

Testing for gas leaks

After the conversion, it is important to check that there are no leaks and that the appearance of the flames is correct.



Installation

After the conversion, complete the Gas Conversion label (part no. 92849A078) and attach it to the rear of the appliance. Do not cover any other labels with the Gas Conversion label.

Minimum adjustment

For natural Gas:

Light the burner and turn the knob to the minimum position. Remove the gas tap knob and turn the adjustment screw at the side of the valve stem until the desired minimum flame is achieved.

1. Light the burner and turn it to the minimum position.
2. Remove the knobs by pulling them upwards.
3. Turn the adjustment screw on the side of the valve stem until a steady minimum flame is achieved.
4. Replace the knob and check that the burner flame is stable.
5. Turn the knob quickly from maximum to minimum: The flame should not go out. Repeat the procedure on all the gas taps.

For LP Gas:

Turn off the burners and unplug the appliance from the electric power supply. To adjust the minimum flame setting for LPG, turn the screw at the side of the valve stem fully clockwise. Once the regulation has been completed, replace the seal on the by-passes using paint or similar materials.

Lubricating the surface burner gas valves

Over time, the surface burner gas valves may become stiff or jam. Clean them internally and re-lubricate. This operation

must be carried out by a qualified technician.

Conversion to natural gas

This appliance is shipped from the factory for use with natural gas. If the appliance was previously converted to propane gas, you have to convert it back to natural gas. Check the orifices for the right nozzles and, if required, replace them. Adjust the minimum gas flow.

The optimum setting is achieved when the height of the small flame is approx. $\frac{1}{8}$ " (3 to 4 mm).

Set the pressure regulator for natural gas.

Turn the spring plate the other way around as shown in "Setting the pressure regulator for propane gas".

Save the nozzles removed from the appliance for future use.



1.4 Electrical requirements



WARNING

Electrical shock hazard

- This appliance is fitted with a three-prong grounding plug for your protection against the risk of electric shock and it should be plugged directly into a properly grounded receptacle. Do not cut or remove the grounding prong from this plug.
- Do not cut or remove the grounding prong.
- Do not use an adaptor.
- Do not use an extension cord.
- Check with a qualified electrician if you are not sure whether the appliance is grounded.



FAILURE TO FOLLOW THESE INSTRUCTIONS COULD RESULT IN LOSS OF LIFE, FIRE OR ELECTRICAL SHOCK.

Make sure that the power supply rating matches the rating indicated on the ID plate. The ID plates are located in a visible position on the back of the appliances.

These ID plates must never be removed.

- Wire size and connections must conform to the requirements of the National Electrical Code, ANSI/NFPA 70 ELECTRICAL CODE (*) – last edition or CSA Standard C22.1-94, Canadian Electrical code, Part 1 (**) and CSA C22.2 No. 0-91 or latest edition and all local codes and ordinances for the kilowatt rating of the appliance. **IMPORTANT:** Observe all governing codes and ordinances.
- It goes without saying that your local codes and ordinances take precedence over these instructions. Complete electrical connections according to local codes and ordinances.
- Where codes permit and a separate grounding wire is used, it is recommended that the suitability of the ground path be checked by a qualified electrician.
- Consult a qualified electrician if you are not sure whether the appliance is properly grounded. Do not ground to a gas pipe.
- A 120-volt, 60-Hz, AC-only, 15-ampere, fused electrical supply is required. A time-delay fuse or circuit breaker is recommended. It is recommended that a separate circuit serving only this appliance be provided.



Installation

Recommended Grounding Method

For your personal safety, this appliance must be grounded. This appliance is fitted with a 3-prong grounding plug. To minimize the risk of electric shock, the cord must be plugged into a mating 3-prong grounding receptacle that is grounded in accordance with the National Electrical Code ANSI/NFPA 70 (latest edition *) or the Canadian Electrical Code (CSA) ** and local codes and ordinances.

If a mating receptacle is not available, it is the customer's personal responsibility and obligation to have a properly polarized and grounded 3-prong outlet installed by a qualified electrician.

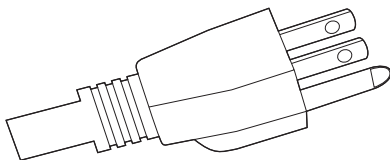

NOTE: Copies of the standards listed above may be obtained from:

* National Fire Protection Association, 1 Batterymarch Park, Quincy, Massachusetts 02169-7471

** CSA International, 8501 East Pleasant Valley Road, Cleveland OH 44131-5575

1.5 For the installer

- The plug must remain accessible after the installation is complete. Do not kink or trap the mains connection cable.
- The appliance must be fitted according to the installation diagrams.
- When satisfied with the appliance, please instruct the user on the correct method of operation.
- Do not attempt to turn or stress the threaded elbow on the manifold. You risk damaging this part of the appliance, which may invalidate the manufacturer's warranty.
- Before leaving, check all connections for gas leaks with soap and water. **DO NOT** use a naked flame for detecting leaks.
- Ignite all burners individually and concurrently to ensure correct operation of the gas valves, burner and ignition.
- Turn the gas knobs to the low position and observe stability of the flame for each burner individually and all together.
- If the appliance is still not working properly after all checks have been carried out, contact the Authorized Assistance Center in your area.
- When satisfied with the appliance, please instruct the user on the correct method of operation.
- **LEAVE THESE INSTRUCTIONS WITH APPLIANCE AFTER INSTALLATION IS COMPLETE.**